

ASPHALT

UINTAH County of Utah

Effective Date: 9/5/2007

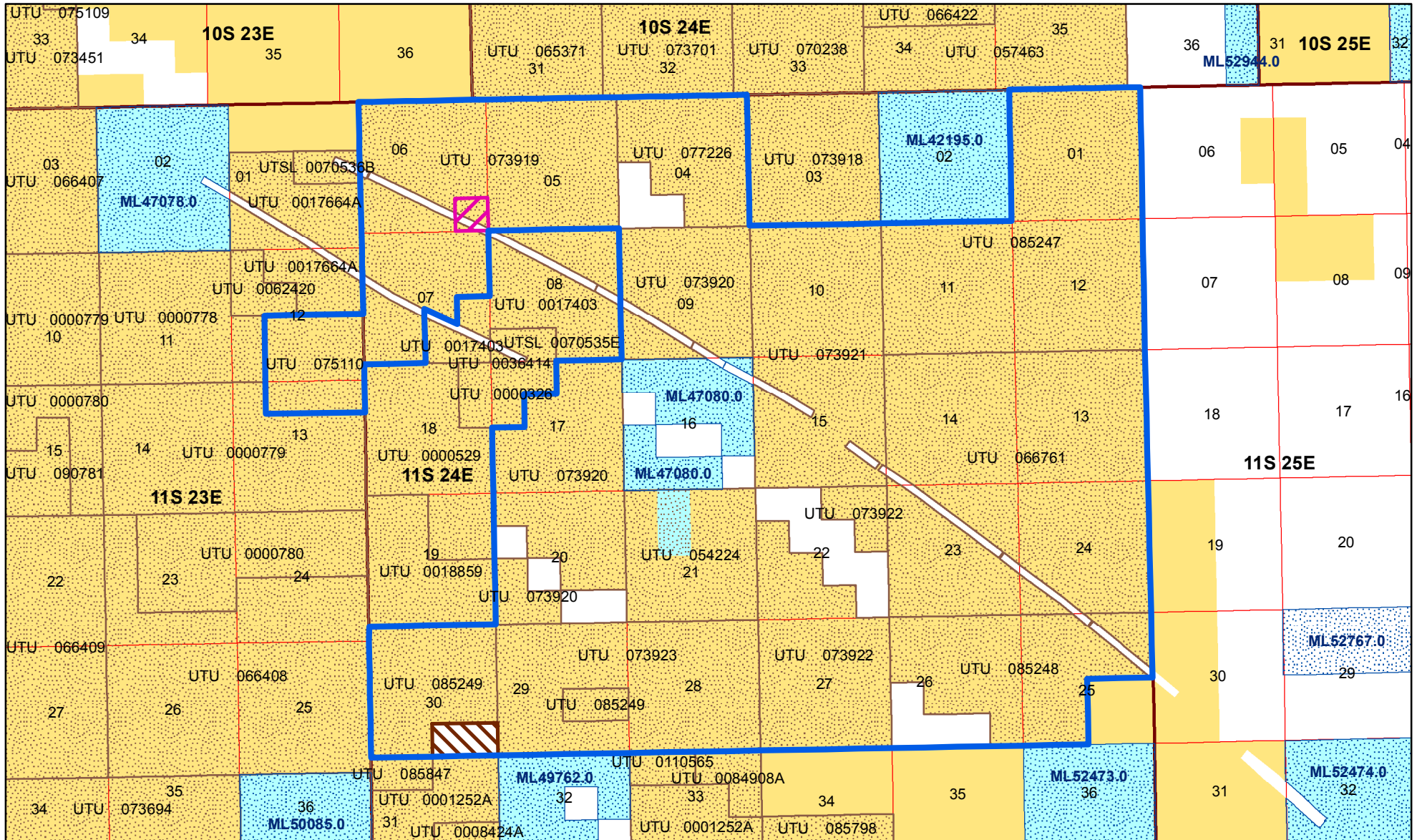

- PA= Participating Area Names**
- PA= Wasatch-Mesaverde "A" UTU 084718A
 - Oil and Gas Unit Agreement
 - Uncommitted Unit Tracts
 - Unleased Federal Unit Tracts

- Oil and Gas Lease Parcels**
- Authorized Oil and Gas Lease Parcels
 - Pending Oil and Gas Lease Parcels
 - SITLA Oil and Gas Lease Parcels

UTU 084718X
Acres: 15883.99

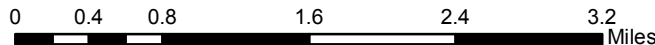

- Bureau of Land Management (BLM)
- US Forest Service (USFS)
- National Park Service (NPS)
- Indian Reservation (IR)
- State
- Private
- Township
- Section

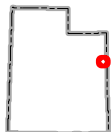

Date: 1/5/2018