

**WILDERNESS INVENTORY MAINTENANCE
IN BLM OREGON/WASHINGTON**

Year: 2008

Inventory Unit Number/Name: West Warm Springs Unit 4

**FORM 1: DOCUMENTATION OF BLM WILDERNESS INVENTORY
FINDINGS ON RECORD:**

1. Is there existing BLM wilderness inventory information on all or part of this area?

No _____ Yes X (if more than one unit is within the area, list the names/numbers of those units):

a) Inventory Source: Wilderness Inventory, Proposed Initial Inventory – Roadless Areas and Islands Which Clearly Do Not Have Wilderness Characteristics, Oregon and Washington, April 1979

b) Inventory Unit Name(s)/Number(s): 2-36

c) Map Name(s)/Number(s): April 1979 Map

d) BLM District(s)/Field Office(s): Burns District – Three Rivers Resource Area

2. BLM Inventory Findings on Record:

Existing inventory information regarding wilderness characteristics (if more than one BLM inventory unit is associated with the area, list each unit and answer each question individually for each inventory unit):

Inventory Source: Wilderness Inventory, Proposed Initial Inventory – Roadless Areas and Islands Which Clearly Do Not Have Wilderness Characteristics, Oregon and Washington – no narrative was provided for this unit it was only displayed on map as previously inventoried BLM unit found not to have wilderness characteristics.

Unit#/Name	Size (bistoric acres)	Natural Condition? Y/N	Outstanding Solitude? Y/N	Outstanding Primitive & Unconfined Recreation? Y/N	Supplemental Values? Y/N
2-36	Not provided	N	N	N	N

**FORM 2 - DOCUMENTATION OF CURRENT WILDERNESS
INVENTORY CONDITIONS**

Unit Number/Name: West Warm Springs Unit 4

(1) Is the unit of sufficient size?

Current Unit Acres: 7,642 Yes X No _____

[State the BLM acreage of the unit. Describe the boundaries of the unit (roads, property lines, etc.) If the area meets one of the exceptions to the size criterion, check "Yes" and describe the exception. If more than one inventory unit is involved, list the acreage in each and evaluate each unit/subunit separately. Complete the analysis for (1), (2), (3),(4) and (5) for each unit or sub-unit. If you check "No" above, check "N/A" (Not Applicable) in the remaining boxes below, and you need not provide additional evaluation for the unit or subunit. Use additional space as necessary].

Description of the Current Conditions: (Include land ownership, location, topography, vegetation features and summary of major human uses/activities).

Citizen Information Received: On September 19, 2007 the BLM received a citizen proposal from the Oregon Natural Desert Association (ONDA) for the 462,828-acre Buzzard Creek proposed WSA. ONDA included in their information a narrative report, maps, photos, photo and route logs and GIS data with their route and photo point data, all of which were considered as part of the wilderness inventory maintenance process for this BLM Unit. The photos submitted by ONDA were taken in July of 2004 and June of 2005. They identified the Buzzard Creek proposed WSA as having no routes which meet their definition of a boundary road and included state land within their proposal.

As part of BLM's boundary determination process, it was determined that several of ONDA's "ways" are still boundary roads. It is BLM's finding that ONDA's Buzzard Creek proposed WSA is not one large roadless unit, but is made of several smaller units that are similar, though not exactly the same, as those units identified by the 1979 and 1980 wilderness inventory effort.

Boundary changes since 1979: The boundaries for Unit 4 appear similar to those identified (See Unit Boundary Map 1) for Subunit 2-36, except the northern boundary is now a developed powerline right-of-way and the western portion of the unit is now state land.

Current Unit Boundaries:

See Unit Character Map for Photo Point (Pt.) Locations

N: Developed powerline right-of-way and Big Stick Road – Same as ONDA proposed unit boundary.

E: Road 7256-0-00 (ONDA Photo Pts. FR-29 NW, FR-9 S) and private land. While there is minimal vegetation in the center of the road, it is not overgrown and is in a useable condition and does continue to get relatively regular use.

S: Road 7251-0-A0 (BLM Route Analysis #20, Photo Pt. A10) (No ONDA Photo Pts)

W: State land

Note: Other ONDA photo pts. did not appear to be of boundary roads for this BLM unit.

The ID-team confirmed that based on their knowledge of the area and reviewing ONDA information and the BLM information gathered as part of the unit boundary determination process, that these routes do meet boundary road criteria.

ONDA also included state land in their proposed Buzzard Creek WSA. BLM does not have the authority to evaluate wilderness characteristics on state land, so it was not included in this unit.

(2) Is the unit in a natural condition?

Yes _____ No X N/A _____

Current Condition Description: The ID-team reviewed photos from the 1977 inventory effort and landscape related photos provided by ONDA. The unit is located approximately nine miles east of the community of Wagontire. The topographic relief is limited to a few rolling hills and scattered rimrock. The dominant vegetation is sagebrush and grasses. The primary human uses in the unit and the surrounding area are associated with livestock grazing and recreation by the public. The southwest corner of the unit near Jack Smart Lakebed also gets some OHV use.

The roads along the eastern boundary have had recent brush beating. This consists of mowing sagebrush (24 feet) on either side of the road to assist with providing a fire break (**See Unit Brush Beating Map**). The unit includes a 1,298-acre brush beating project that was completed in 2005. The unit currently has the following developments (**See Unit Character Map**):

- 2.6 miles of interior routes (non-boundary roads)

- 1 Reservoir
- 4 miles of fencing – though this fencing is along the property line on the outer edge of the unit

Team Members:

Laura Dowlan
Wilderness Specialist
Bob Sharp
Range Manager
Paul McDonald
Supervisor

The ID-team found that the imprint of humans is substantially noticeable, given the size of the brush beating project and its central location in a relatively small unit. As the brush beating area grows back in the short term (unless the treatment is repeated), this unit would likely return to a natural appearance in the long term. This finding is not consistent with ONDA's proposal for their Buzzard Creek Unit, which they found to be natural as a whole, however much of ONDA's finding of naturalness was due to developments and treatments being substantially unnoticeable across their entire Buzzard Creek Unit.

(3) Does the unit have outstanding opportunities for solitude?

Yes No N/A *8/25/08*

(4) Does the unit have outstanding opportunities for primitive and unconfined recreation?

Yes No N/A *8-12-2008*

(5) Does the unit have supplemental values?

Yes No N/A *8/24/08*

Summary of Findings and Conclusion

Unit Name and Number: West Warm Springs Unit 4 *8-11-2008*

Summary Results of Analysis:

1. Does the area meet any of the size requirements? Yes No
2. Does the area appear to be natural? Yes No
3. Does the area offer outstanding opportunities for solitude or a primitive and unconfined type of recreation? Yes No NA
4. Does the area have supplemental values? Yes No NA

Conclusion (Check One):

- The area-or a portion of the area-has wilderness character.
- The area does not have wilderness character.

Prepared by: Laura Dowlan, Wilderness Specialist

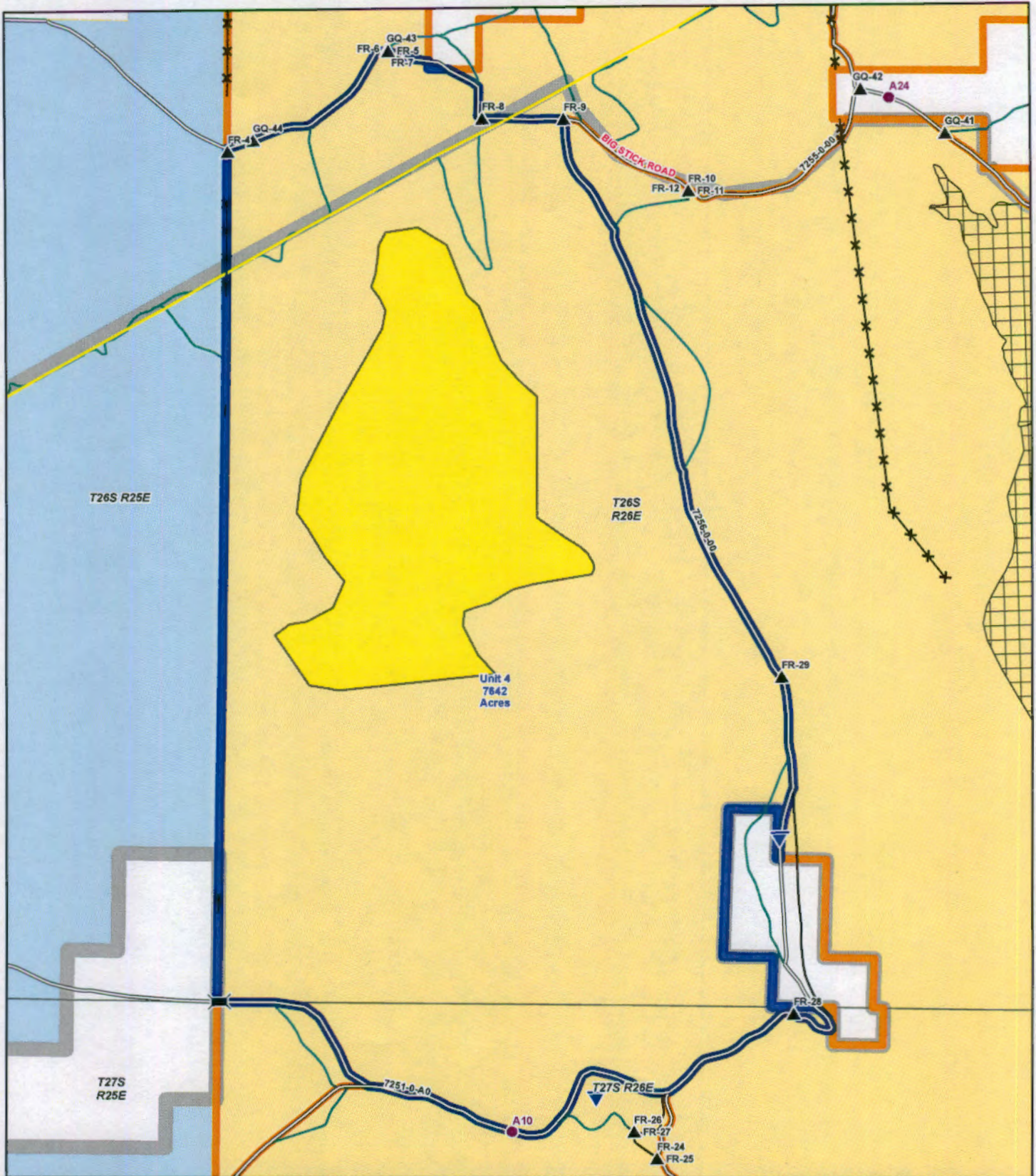

West Warm Springs Wilderness Character Unit Map ~ 4

- | | | | | |
|-------------------------|-------------------------|-------------|-----------------|----------------------------|
| Unit | Mineral Materials Sites | STUDY PLOT | BRUSHBEAT | Powerline |
| Adjacent Units | CATTLE GUARD | TANK | DIKE | Unit Boundary Roads |
| BLM Photo Points | CORRAL | WATERHOLE | DRIFT FENCE | Interior Primitive Roads |
| ONDA Photo Points | GATE | WELL | FENCE | Bureau of Land Management |
| ONDA Unit Buzzard Creek | RESERVOIR | Major Roads | PIPELINE | BLM Wilderness Study Area |
| Burns District Boundary | | | SNOW FENCE | State |
| | | | EXCLOSURE FENCE | U.S. Fish & Wildlife |
| | | | SEEDING | No. Great Basin Exp. Range |
| | | | | Private |

Note: No warranty is made by the Bureau of Land Management as to the accuracy, reliability or completeness of these data for individual or aggregate use with other data. Original data was compiled from various sources. This information may not meet National Map Accuracy Standards. This product was developed through digital means and may be updated without notification. Ownership boundaries are accurate to within plus or minus 200 feet.

US DEPARTMENT OF THE INTERIOR
 Bureau of Land Management
 Burns District, Oregon
 Three Rivers Resource Area

projects\WSAInventoryReview\WestWarmSp\IndividualUnitBX11NoAnno.mxd for Laura Dowlan
 January 11, 2007

0 0.2 0.4 0.8 Miles