

**WILDERNESS INVENTORY MAINTENANCE  
IN BLM OREGON/WASHINGTON**  
(Source: Oregon State Office Internal Guidance as of July 2007)

Year: 2008      Inventory Unit Number/Name: West Warm Springs Unit 23

**FORM 1: DOCUMENTATION OF BLM WILDERNESS INVENTORY  
FINDINGS ON RECORD:**

**1. Is there existing BLM wilderness inventory information on all or part of this area?**

No \_\_\_\_\_ Yes   X   (if more than one unit is within the area, list the names/numbers of those units):

a) Inventory Source: Wilderness Inventory – OR/WA Final Intensive Inventory Decisions (November 1980), Pages 48-49

b) Inventory Unit Name(s)/Number(s): Robinson Lake Subunit 1-57A

c) Map Name(s)/Number(s): November 1980 Map

Note: in reviewing the 1980 map and the narrative for the units, it was discovered that the map had incorrectly switched the labeling of subunits 1-57A as 1-57 B

d) BLM District(s)/Field Office(s): Burns District – Three Rivers Resource Area and Lakeview District – Lakeview Resource Area.

**2. BLM Inventory Findings on Record:**

Existing inventory information regarding wilderness characteristics (if more than one BLM inventory unit is associated with the area, list each unit and answer each question individually for each inventory unit):

Inventory Source: Wilderness Inventory – OR/WA Final Intensive Inventory Decisions (November 1980), Pages 48-49

Unit#/Name	Size (historic acres)	Natural Condition? Y/N	Outstanding Solitude? Y/N	Outstanding Primitive & Unconfined Recreation? Y/N	Supplemental Values? Y/N
1-57A	17,360	N	N	N	N



**FORM 2 - DOCUMENTATION OF CURRENT WILDERNESS  
INVENTORY CONDITIONS**

Unit Number/Name: West Warm Springs Unit 23

**(1) Is the unit of sufficient size?**

Current Unit Acres: 15,257 Yes X No \_\_\_\_\_

[State the BLM acreage of the unit. Describe the boundaries of the unit (roads, property lines, etc.) If the area meets one of the exceptions to the size criterion, check "Yes" and describe the exception. If more than one inventory unit is involved, list the acreage in each and evaluate each unit/subunit separately. Complete the analysis for (1), (2), (3),(4) and (5) for each unit or sub-unit. If you check "No" above, check "N/A" (Not Applicable) in the remaining boxes below, and you need not provide additional evaluation for the unit or subunit. Use additional space as necessary].

**Description of the Current Conditions:** (Include land ownership, location, topography, vegetation features and summary of major human uses/activities).

**Citizen Information Received:** On September 19, 2007 the BLM received a citizen proposal from the Oregon Natural Desert Association (ONDA) for the 462,828-acre Buzzard Creek proposed WSA. ONDA included in their information a narrative report, maps, photos, photo and route logs and GIS data with their route and photo point data, all of which were considered as part of the wilderness inventory maintenance process for this BLM Unit. The photos submitted by ONDA were taken in July of 2004 and June of 2005. They identified the Buzzard Creek proposed WSA as having no routes which meet their definition of a boundary road and included state land within their proposal.

As part of BLM's boundary determination process, it was determined that several of ONDA's "ways" are still boundary roads. It is BLM's finding that ONDA's Buzzard Creek proposed WSA is not one large roadless unit, but is made of several smaller units that are similar, though not exactly the same, as those units identified by the 1979 and 1980 wilderness inventory effort.

**Boundary changes since 1980:** The boundaries for Unit 23 appear similar to those identified (See Unit Boundary Map 2) for subunit 1-57 A (incorrectly labeled 1-57B on the map) except Robinson Valley Road splits off a portion of the unit along the southwest boundary making it



smaller overall, however additional acres were added to the unit due to a non-federal inholding becoming BLM land.

**Current Unit Boundaries:**

**See Unit Character Map for Photo Point (Pt.) Locations**

**N & E:** Road 7256-0-100 (BLM Route Analysis #5, Photo Pts. A6 & A7) (ONDA Photo Pts. FK-18 WNW, FK-22 NNW, FK-24 WNW, FK-25 NNE, FK-27 SE, FK-28 NNW)

**N & W:** Road 7256-0-1H (BLM Route Analysis #42, Photo Pts. A34 & A35) (ONDA Photo Pts. FK-69 SE, CZ-4 SSW) and Road 7175-0-C (no BLM but evaluated as part of Route Analysis #42) (no ONDA photos)

**S & W:** Road 7175-0-D (BLM Route Analysis #18, Photo Pt. R16) (ONDA Photo Pts. FK-75 N) and three interior short spur roads

**S:** Road 7175-0-00 matches ONDA Unit Boundary (BLM Route Analysis #19, Photo Pt. R17) (ONDA Photo Pts. FK-76)

**Note: Other ONDA photo pts. did not appear to be of boundary roads for this BLM unit.**

Both ID-teams from the Burns and Lakeview districts confirmed that based on their knowledge of the area and reviewing ONDA information and the BLM information gathered as part of the unit boundary determination process, that these routes do meet boundary road criteria.

**(2) Is the unit in a natural condition?**

Yes \_\_\_\_\_ No  X  N/A \_\_\_\_\_

**1980 Unit Description:** The unit is located approximately 30 miles southeast of the community of Wagontire. The 1980 Inventory Report described this unit as having somewhat rolling terrain on the west with broader flat areas in the remaining portions. The unit contains five fairly large lakebeds at Flynn, Robinson and Junction Lakes. The vegetation in the subunit is primarily big sagebrush. There are several developments including a fence line running north and south, and paralleled by a broad vehicle way, that are substantially noticeable. The subunit does not appear to be primarily affected by the forces of nature because the impacts of these developments are substantially noticeable.

**Current Condition Description:** The ID-team reviewed photos from the landscape related photos provided by ONDA. The primary human uses in the unit and the surrounding area are associated with livestock grazing and recreation by the public. With the new boundary, the size of the unit is smaller and in addition to the developments present, almost all of the



boundary roads around the unit have had brush beating, which consists of mowing sagebrush (24 feet) on either side of the road to assist with providing a fire break. The unit currently has the following developments or vegetative treatments (See Unit Character Map):

- 8.1 miles of interior routes (non-boundary roads)
- 9 miles of fencing. All the fences also have an interior route running along them not reflected in the mileage estimates above.
- 2 reservoirs and 2 waterholes

Given the location and distribution of developments through out the unit, and the irregular shape of the unit and the brush beating treatments around the unit, the imprints of humans were found to be substantially noticeable and the unit was found not to have naturalness. This finding is not consistent with ONDA's proposal for their Buzzard Creek Unit, which they found to be natural as a whole; however, much of ONDA's finding of naturalness was due to developments and treatments being substantially unnoticeable across their entire Buzzard Creek Unit.

**(3) Does the unit have outstanding opportunities for solitude?**

Yes \_\_\_\_\_ No \_\_\_\_\_ N/A X

**(4) Does the unit have outstanding opportunities for primitive and unconfined recreation?**

Yes \_\_\_\_\_ No \_\_\_\_\_ N/A X

**(5) Does the unit have supplemental values?**

Yes \_\_\_\_\_ No \_\_\_\_\_ N/A X

### Summary of Findings and Conclusion

Unit Name and Number: West Warm Springs Unit 23

### Summary Results of Analysis:

1. Does the area meet any of the size requirements? X Yes \_\_\_ No
2. Does the area appear to be natural? \_\_\_ Yes X No
3. Does the area offer outstanding opportunities for solitude or a primitive and unconfined type of recreation? \_\_\_ Yes \_\_\_ No X NA
4. Does the area have supplemental values? \_\_\_ Yes \_\_\_ No X NA



**Conclusion (Check One):**

The area-or a portion of the area-has wilderness character.

The area does not have wilderness character.

**Prepared by: Laura Dowlan, Wilderness Specialist**



**Team Members:**

Laura Dowlan 8/4/08  
Date  
Laura Dowlan, Outdoor Recreation Planner (Wilderness Specialist) – Burns District

Brett Page 8/20/08  
Date  
Brett Page, Outdoor Recreation Planner – Burns District

Nick Miller 8/18/08  
Date  
Nick Miller, Wildlife Biologist – Burns District

Rob Sharp 8/25/2008  
Date  
Rob Sharp, Range Management Specialist – Burns District

Ronda L. Purdy 8-13-2008  
Date  
Ronda Purdy, Range Technician – Burns District

Fred McDonald 8/22/08  
Date  
Fred McDonald, Supervisory Natural Resource Specialist – Burns District

Willie Street 8-11-2008  
Date  
Willie Street, Range Management Specialist – Burns District

Autumn Richardson 8-11-2008  
Date  
Autumn Richardson, SCEP Range Management Specialist – Burns District

Kim McLean 9/15/08  
Date  
Kim McLean, Outdoor Recreation Planner – Lakeview District

Paul Whitman 9/12/2008  
Date  
Paul Whitman, Planning & Environmental Coordinator – Lakeview District

Jayna Ferrell 9/12/08  
Date  
Jayna Ferrell, Range Management Specialist – Lakeview District

Todd Forbes 9/2/08  
Date  
Todd Forbes, Associate Field Manager – Lakeview District

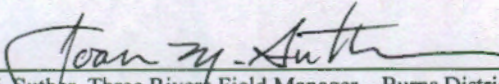

**Approved by:**

  
Joan M. Suther, Three Rivers Field Manager – Burns District

8/31/08  
Date

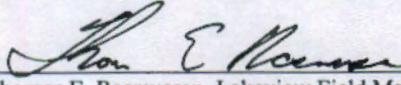
  
Thomas E. Rasmussen, Lakeview Field Manager – Lakeview District

9/19/08  
Date

*This form documents information that constitutes an inventory finding on wilderness characteristics. It does not represent a formal land use allocation or a final agency decision subject to administrative remedies under either 43 CFR parts 4 or 1610.5-2.02*

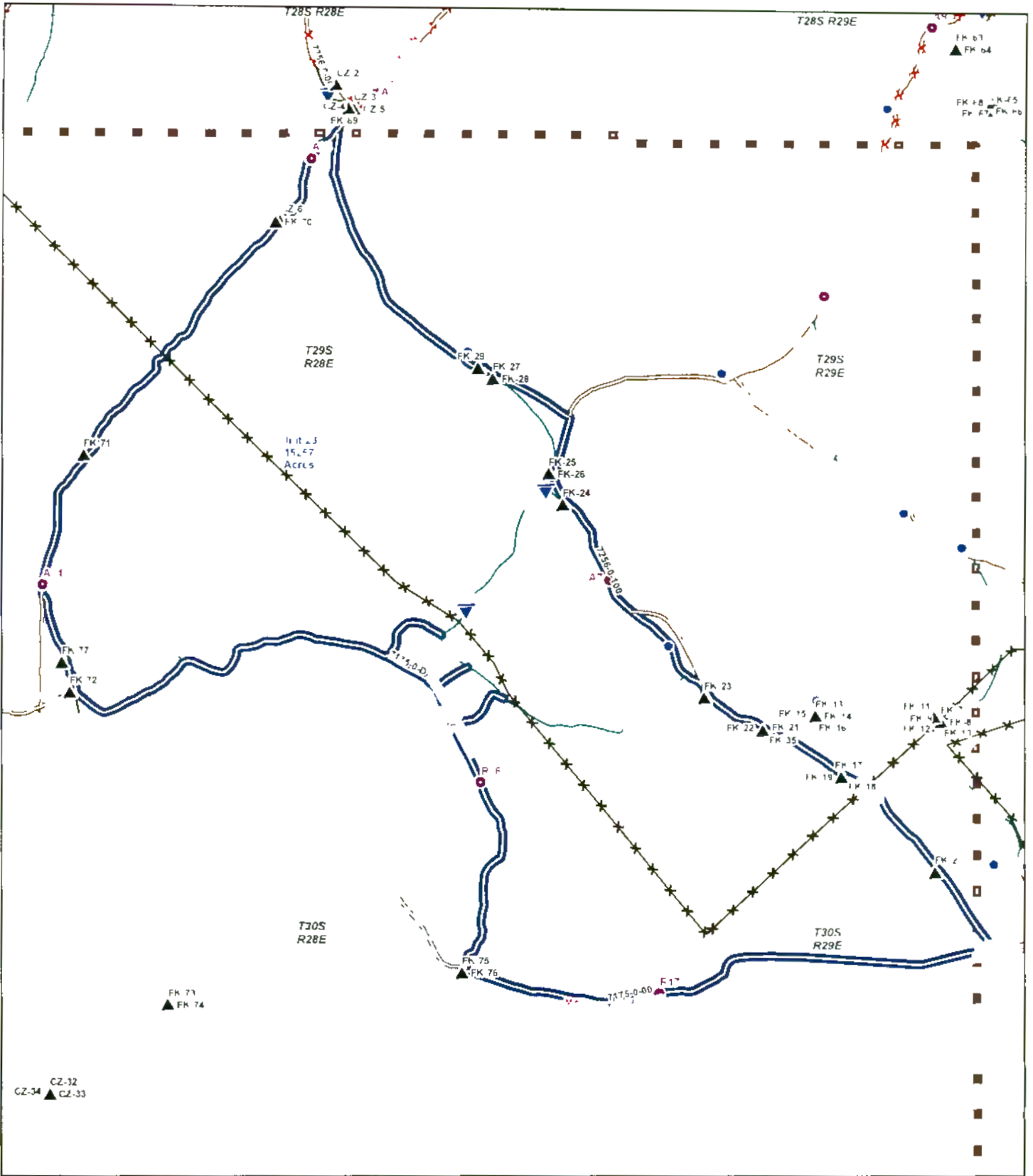

**West Warm Springs Wilderness Character Unit Map 23**

UNIT	Mineral Materials Sites	STUDY PLOT	BRUSHBEAT	Powerline	Wilderness 2002 to Present
BLM Photo Points	CATTLE GUARD	WATERHOLE	DIKE	Unit Boundary Roads	<b>Land Administration</b>
ONDA Photo Points	CORRAL	WELL	DRIFT FENCE	Interior Primitive Roads	Bureau of Land Management
GATE	RESERVOIR	Major Roads	FENCE	PIPELINE	BLM Wilderness Study Area
Burne District Boundaries					State
					U.S. Fish & Wildlife
					No. Great Basin Exp. Range
					Private

0 0.35 0.7 1.4 Miles