

**WILDERNESS INVENTORY MAINTENANCE  
IN BLM OREGON/WASHINGTON  
(Source: Oregon State Office Internal Guidance as of July 2007)**

Year: 2008 Inventory Unit Number/Name: West Warm Springs Unit 20

**FORM 1: DOCUMENTATION OF BLM WILDERNESS INVENTORY  
FINDINGS ON RECORD:**

**1. Is there existing BLM wilderness inventory information on all or part of this area?**

No \_\_\_\_\_ Yes  X  (if more than one unit is within the area, list the names/numbers of those units):

a) Inventory Source: Wilderness Inventory – OR/WA Final Intensive Inventory Decisions (November 1980), Page 144

b) Inventory Unit Name(s)/Number(s): Buzzard Creek Subunit 2-64A

c) Map Name(s)/Number(s): November 1980 Map

d) BLM District(s)/Field Office(s): Burns District – Three Rivers Resource Area and Lakeview District – Lakeview Resource Area.

**2. BLM Inventory Findings on Record:**

Existing inventory information regarding wilderness characteristics (if more than one BLM inventory unit is associated with the area, list each unit and answer each question individually for each inventory unit):

Inventory Source: Wilderness Inventory – OR/WA Final Intensive Inventory Decisions (November 1980), Page 144.

Unit#/Name	Size (historic acres)	Natural Condition? Y/N	Outstanding Solitude? Y/N	Outstanding Primitive & Unconfined Recreation? Y/N	Supplemental Values? Y/N
2-64A	14,140	Y	N	N	Y



**FORM 2 - DOCUMENTATION OF CURRENT WILDERNESS  
INVENTORY CONDITIONS**

Unit Number/Name: West Warm Springs Unit 20

**(1) Is the unit of sufficient size?**

Current Unit Acres: 14,945 Yes X No \_\_\_\_\_

[State the BLM acreage of the unit. Describe the boundaries of the unit (roads, property lines, etc.) If the area meets one of the exceptions to the size criterion, check "Yes" and describe the exception. If more than one inventory unit is involved, list the acreage in each and evaluate each unit/subunit separately. Complete the analysis for (1), (2), (3),(4) and (5) for each unit or sub-unit. If you check "No" above, check "N/A" (Not Applicable) in the remaining boxes below, and you need not provide additional evaluation for the unit or subunit. Use additional space as necessary].

**Description of the Current Conditions:** (Include land ownership, location, topography, vegetation features and summary of major human uses/activities).

**Citizen Information Received:** On September 19, 2007 the BLM received a citizen proposal from the Oregon Natural Desert Association (ONDA) for the 462,828-acre Buzzard Creek proposed WSA. ONDA included in their information a narrative report, maps, photos, photo and route logs and GIS data with their route and photo point data, all of which were considered as part of the wilderness inventory maintenance process for this BLM Unit. The photos submitted by ONDA were taken in July of 2004 and June of 2005. They identified the Buzzard Creek proposed WSA as having no routes which meet their definition of a boundary road and included state land within their proposal.

As part of BLM's boundary determination process, it was determined that several of ONDA's "ways" are still boundary roads. It is BLM's finding that ONDA's Buzzard Creek proposed WSA is not one large roadless unit, but is made of several smaller units that are similar, though not exactly the same, as those units identified by the 1979 and 1980 wilderness inventory effort.

**Boundary changes since 1980:** The boundaries for Unit 20 appear very similar to those identified (See Unit Boundary Map 2) for subunit 2-64A. However a block of non-federal land that was in the subunit 2-64A is now BLM land, making the unit slightly larger.



**Current Unit Boundaries:**

**See Unit Character Map for Photo Point (Pt.) Locations**

**North Half:** Flybee-Moon Lake Road 7256-0-G0 (BLM Route Analysis #43, Photo Pt. A36) (ONDA Photo Pt. FK 34 and CZ3)

**SE:** Road 7256-0-1J and 7256-0-2J0 (BLM Route Analysis #6, Photo Pt. A8 and A9) (No ONDA Photo Pt.)

**SW:** Road 7256-0-100 (ONDA Photo Pt. FK 27 and FK 28) there is only minimal vegetation in this road consisting primarily of grasses. It is still in a useable condition and does receive relatively regular use.

**Note:** Other ONDA photo pts. did not appear to be of boundary roads for this BLM unit.

Both ID-teams from the Burns and Lakeview districts confirmed that based on their knowledge of the area and reviewing ONDA information and the BLM information gathered as part of the unit boundary determination process, that these routes do meet boundary road criteria.

**(2) Is the unit in a natural condition?**

Yes  X  No   N/A

**1980 Unit Description:** The unit is located approximately eight miles southwest of Harney Lake, and about 28 miles southeast of the community of Wagontire. The 1980 Inventory Report described this unit as containing an extensive terrace with some scattered rimrock and rolling hills. Deep Canyon, a broad and open drainage, traverses the south and southeast portions. Big and low sagebrush are the dominant vegetation types. Though several developments were identified, the unit was found to be in a natural condition.

**Current Condition Description:** The ID-team reviewed photos from the 1977 inventory effort and landscape related photos provided by ONDA. The general description above is still accurate with addition of playas being present. Brush beating has occurred along some of the boundary roads within the last three years. This consists of mowing sagebrush (24 feet) on either side of the road to assist with providing a fire break. The primary human uses in the unit and the surrounding area are associated with livestock grazing and recreation by the public. The unit currently has the following developments (**See Unit Character Map**):

- 1.3 miles of interior routes (non-boundary roads)
- 4 water holes



The ID-team found that many of these developments were along the outer edges of the unit or dispersed enough that the imprint of humans is still substantially unnoticeable and that the unit is in a natural condition. This finding is generally consistent with ONDA's proposal for their Buzzard Creek Unit, which they found to be natural as a whole.

**(3) Does the unit have outstanding opportunities for solitude?**

Yes \_\_\_\_\_ No  X  N/A \_\_\_\_\_

**1980 Unit Description:** The north portion is flat and open, and it does not provide sufficient area for seclusion. Deep Canyon is in the middle of the area and would provide the best opportunity for solitude. However, there is not enough elevation difference around the drainage for the visitors to sufficiently screen themselves from others in the area. The remaining south portion consists of broad, open rolling hills which would allow the visitor to be highly visible. The area does not offer outstanding solitude.

**Current Condition Description:** The general description above is still accurate. ONDA's report indicated that the sheer size of their proposed Buzzard Creek WSA with endless rolling hills, rimrock ridges, and juniper stands (not present in this unit) make the opportunities for solitude outstanding.

BLM found that ONDA's proposed Buzzard Creek WSA is not one large roadless area, but rather several smaller units, including this BLM unit. The ID-team concurred with the original inventory finding that this portion of Deep Creek Canyon was not large enough to provide for sufficient topographic screening and that this unit does not offer outstanding opportunities for solitude.

**(4) Does the unit have outstanding opportunities for primitive and unconfined recreation?**

Yes \_\_\_\_\_ No  X  N/A \_\_\_\_\_

**1980 Unit Description:** Opportunities for hunting, viewing wildlife, horseback riding, and hiking are present in this area, however they are not outstanding.

**Current Condition Description:** The ID-team found that the recreation opportunities identified above are likely still present. ONDA's report also identified backpacking, camping, rock hounding, and photography. ONDA indicated that the sheer size of their proposed Buzzard Creek WSA cannot help but provide for a diverse and exceptional recreational experience and that the endless rolling hills, rimrock ridges, juniper stands and multiple water features, and geologic structures present add to the



interest of their unit. They also indicated they observed several wildlife species including birds of prey, pronghorn antelope, coyotes, badgers, and numerous birds.

The BLM found that ONDA's proposed Buzzard Creek WSA is not one large roadless area, but rather several smaller units, including this BLM unit. While the recreation opportunities identified by both BLM and ONDA may be present, no unique features were identified for this particular BLM unit and the diversity and quality of these recreation opportunities are not unlike that which can be found on much of public lands in eastern Oregon in the Northern Great Basin region. None of the game species generally hunted in the area, including and around this unit, are considered by the State as being unique or rare, thus these opportunities are not outstanding.

After reviewing the information submitted, the ID-team found that the recreation opportunities present are not unique and do not present characteristics either individually or collectively that would result in these recreation activities being outstanding within the unit. Below is additional supporting BLM information related to recreation resources for this unit.

Both the 2003 Lakeview Resource Management Plan and Record of Decision (RMP/ROD) and the 1992 Three Rivers RMP/ROD show that this unit is open to off-road use by motorized vehicles; however, currently most motorized vehicle use appears to be occurring along existing roads for this unit.

Recreation opportunities within the entire Lakeview Resource Area have also been addressed through the designation of extensive and special recreation management areas in the Lakeview RMP/ROD. An extensive recreation management area (ERMA) is defined in the Lakeview RMP/ROD (page 113) as an area "where significant recreation opportunities and problems are limited and explicit recreation management is not required." This inventory unit was included in an ERMA designation along with much of the rest of the lands within the Lakeview District (RMP/ROD, page 84 and Map R-9), further indicating that the existing or potential recreation opportunities available in this area are not outstanding when compared with the rest of the public lands in the Lakeview Resource Area. BLM lands in this unit also fall within the Three Rivers ERMA (Three Rivers RMP/ROD, page 2-108-109, Map R-1).

During the development of the Lakeview RMP/ROD, the BLM classified all of the public lands within the planning area into one of six recreation opportunity spectrum (ROS) classes (primitive, semiprimitive nonmotorized, semiprimitive motorized, roaded natural, rural, and urban). Class definitions and criteria (remoteness, size, evidence of human use,



social setting, and managerial setting) used in developing the ROS classification for lands in the Lakeview Resource Area are available in the in Appendix M2 (Pages A-287-288 and A-291) of the 2001 Draft Lakeview Resource Management Plan and Environmental Impact Statement.

Map R-3 of the Lakeview RMP/ROD shows that this unit falls within the ROS class of semi-primitive motorized. This classification was identified in recognition of the fact that motorized recreational use is allowed and expected. In contrast, those areas identified as falling within a semi-primitive non-motorized class are areas that have a high potential for "outstanding opportunities for primitive and unconfined types of recreation . . . where the use of the area is through non-motorized, non-mechanical means." BLM lands in this unit for the Three Rivers Resource Area have not been classified under the ROS system, but have similar characteristics as those in the Lakeview Resource Area.

**(5) Does the unit have supplemental values?**

Yes \_\_\_\_\_ No \_\_\_\_\_ N/A  X

**Summary of Findings and Conclusion**

Unit Name and Number: West Warm Springs Unit 20

**Summary Results of Analysis:**

1. Does the area meet any of the size requirements?  X  Yes \_\_\_ No
2. Does the area appear to be natural?  X  Yes \_\_\_ No
3. Does the area offer outstanding opportunities for solitude or a primitive and unconfined type of recreation? \_\_\_ Yes  X  No \_\_\_ NA
4. Does the area have supplemental values? \_\_\_ Yes \_\_\_ No  X  NA

**Conclusion (Check One):**

\_\_\_ The area-or a portion of the area-has wilderness character.

X  The area does not have wilderness character.

**Prepared by: Laura Dowlan, Wilderness Specialist**



**Team Members:**

Laura Dowlan 9/4/08  
Date  
Laura Dowlan, Outdoor Recreation Planner (Wilderness Specialist) – Burns District

Brett Page 8/20/08  
Date  
Brett Page, Outdoor Recreation Planner – Burns District

Nick Miller 8/18/08  
Date  
Nick Miller, Wildlife Biologist – Burns District

Rob Sharp 8/25/2008  
Date  
Rob Sharp, Range Management Specialist – Burns District

Ronda L. Purdy 8-13-2008  
Date  
Ronda Purdy, Range Technician – Burns District

Fred McDonald 8/22/08  
Date  
Fred McDonald, Supervisory Natural Resource Specialist – Burns District

Willie Street 8-11-2008  
Date  
Willie Street, Range Management Specialist – Burns District

Autumn Richardson 8-11-08  
Date  
Autumn Richardson, SCEP Range Management Specialist – Burns District

Kim McLean 9/15/08  
Date  
Kim McLean, Outdoor Recreation Planner – Lakeview District

Paul Whitman 9/12/2008  
Date  
Paul Whitman, Planning & Environmental Coordinator – Lakeview District

Jayna Ferrell 9/12/08  
Date  
Jayna Ferrell, Range Management Specialist – Lakeview District

Todd Forbes 8/12/08  
Date  
Todd Forbes, Associate Field Manager – Lakeview District



**Approved by:**

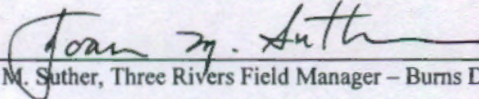

Joan M. Suther, Three Rivers Field Manager – Burns District

8/31/08

Date

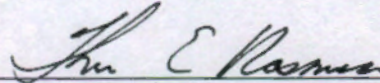

Thomas E. Rasmussen, Lakeview Field Manager – Lakeview District

9/19/08

Date

*This form documents information that constitutes an inventory finding on wilderness characteristics. It does not represent a formal land use allocation or a final agency decision subject to administrative remedies under either 43 CFR parts 4 or 1610.5-2.02*



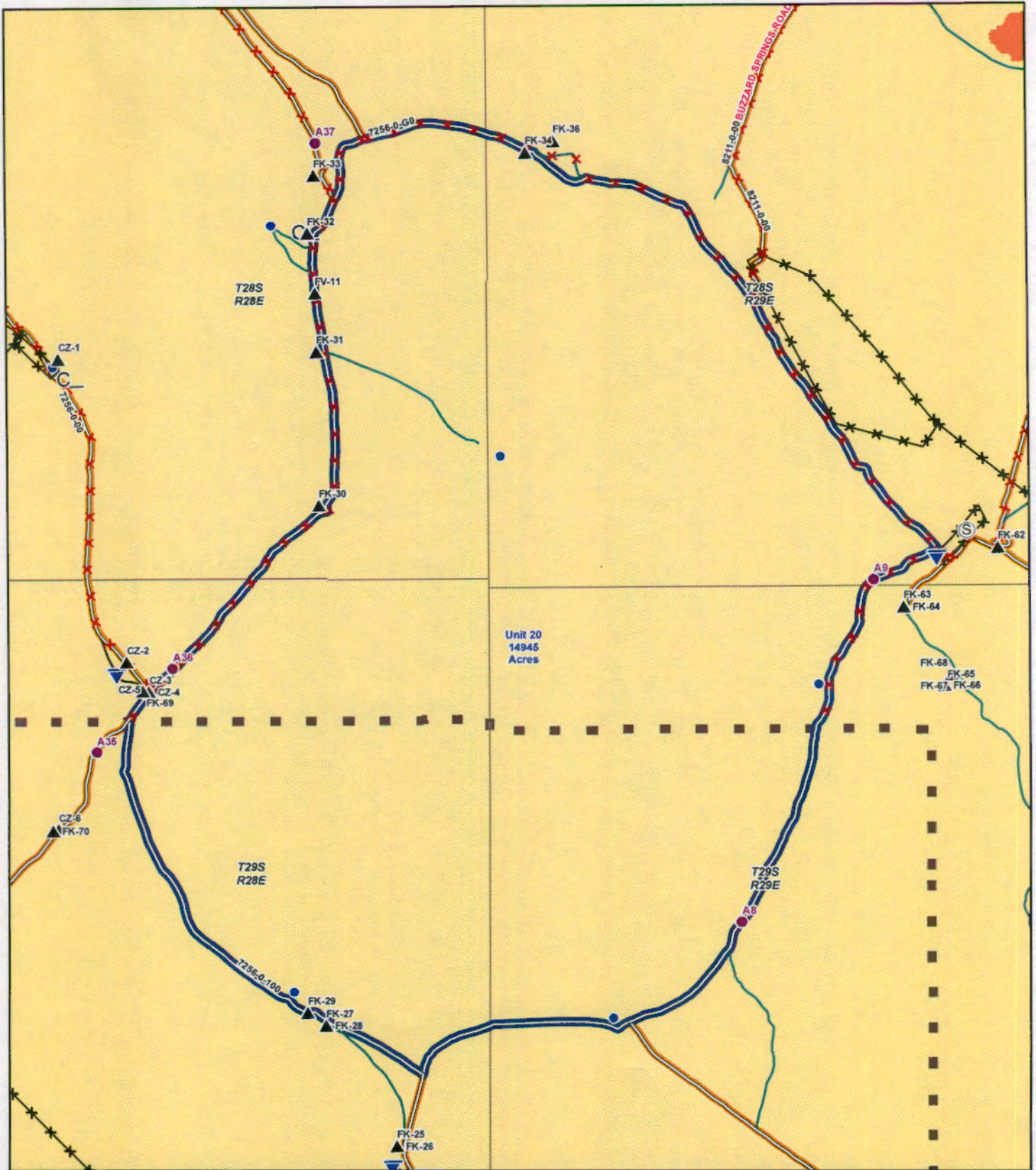

**West Warm Springs Wilderness Character Unit Map ~ 20**

- |                         |                         |             |                 |                            |                           |
|-------------------------|-------------------------|-------------|-----------------|----------------------------|---------------------------|
| Unit                    | Mineral Materials Sites | STUDY PLOT  | BRUSHBEAT       | Powerline                  | Wildfires 2002 to Present |
| Adjacent Units          | CATTLE GUARD            | TANK        | DIKE            | Unit Boundary Roads        | Bureau of Land Management |
| BLM Photo Points        | CORRAL                  | WATERHOLE   | DRIFT FENCE     | Interior Primitive Roads   | BLM Wilderness Study Area |
| ONDA Photo Points       | GATE                    | WELL        | FENCE           | State                      | U.S. Fish & Wildlife      |
| ONDA Unit Buzzard Creek | RESERVOIR               | Major Roads | PIPELINE        | No. Great Basin Exp. Range | Private                   |
| Burns District Boundary |                         |             | SNOW FENCE      | BRUSHBEAT                  |                           |
|                         |                         |             | EXCLOSURE FENCE | SEEDING                    |                           |

Note: No warranty is made by the Bureau of Land Management as to the accuracy, reliability or completeness of these data for individual or aggregate use with other data. Original data was compiled from various sources. This information may not meet National Map Accuracy Standards. This product was developed through digital means and may be updated without notification. Ownership boundaries are accurate to within plus or minus 200 feet.

**US DEPARTMENT OF THE INTERIOR**  
**Bureau of Land Management**  
 Burns District, Oregon  
 Three Rivers Resource Area

projects\WSAInventoryReview\WestWarmSp\IndividualUnit\BX11NoAnno.mxd for Laura Dowlan  
 January 11, 2007  
 All legend elements may not appear on this map.

