

**WILDERNESS INVENTORY MAINTENANCE
IN BLM OREGON/WASHINGTON**

Year: 2008 Inventory Unit Number/Name: West Warm Springs Unit 2

**FORM 1: DOCUMENTATION OF BLM WILDERNESS INVENTORY
FINDINGS ON RECORD:**

1. Is there existing BLM wilderness inventory information on all or part of this area?

No _____ Yes X (if more than one unit is within the area, list the names/numbers of those units):

a) **Inventory Source:** Wilderness Inventory, Proposed Initial Inventory – Roadless Areas and Islands Which Clearly Do Not Have Wilderness Characteristics, Oregon and Washington, April 1979

b) **Inventory Unit Name(s)/Number(s):** 2-32

c) **Map Name(s)/Number(s):** Proposed Initial Inventory Map, April 1979

d) **BLM District(s)/Field Office(s):** Burns District – Three Rivers Resource Area

2. BLM Inventory Findings on Record:

Existing inventory information regarding wilderness characteristics (if more than one BLM inventory unit is associated with the area, list each unit and answer each question individually for each inventory unit):

Inventory Source: These units were found to clearly not have wilderness characteristics present in the April 1979 report, so they were not described in detail.

Unit#/Name	Size (historic acres)	Natural Condition? Y/N	Outstanding Solitude? Y/N	Outstanding Primitive & Unconfined Recreation? Y/N	Supplemental Values? Y/N
NA					

**FORM 2 - DOCUMENTATION OF CURRENT WILDERNESS
INVENTORY CONDITIONS**

Unit Number/Name: West Warm Springs Unit 2

(1) Is the unit of sufficient size?

Current Unit Acres: 12,500 Yes X No _____

[State the BLM acreage of the unit. Describe the boundaries of the unit (roads, property lines, etc.) If the area meets one of the exceptions to the size criterion, check "Yes" and describe the exception. If more than one inventory unit is involved, list the acreage in each and evaluate each unit/subunit separately. Complete the analysis for (1), (2), (3),(4) and (5) for each unit or sub-unit. If you check "No" above, check "N/A" (Not Applicable) in the remaining boxes below, and you need not provide additional evaluation for the unit or subunit. Use additional space as necessary].

Description of the Current Conditions: (Include land ownership, location, topography, vegetation features and summary of major human uses/activities).

Citizen Information Received: NO

Boundary changes since 1979: The boundaries for this unit appear to be similar to those for unit 2-32 in the 1979 report (See Unit Boundary Map 1). There has also a new private land inholding and a parcel that was not federal land and that is now BLM land.

Current Unit Boundaries:

N: BLM Road 7257-0-AO

NE: BLM Road 7257-0-AA (BLM Route Analysis #50, Photo Pts. A45)

S: BLM Big Stick Road and Road 7258-0-00

E: BLM Road 7258-0-A0 (BLM Route Analysis #51, Photo Pts. A46 and BLM Route Analysis #52, Photo Pts. A47)

Interior Boundary Route: Portion of Sieloft Dike Road to the dike.

There are also several private land parcels that are unit boundaries.

The ID-team confirmed that based on their knowledge of the area and reviewing the BLM information gathered as part of the unit boundary determination process that these routes do meet boundary road criteria.

(2) Is the unit in a natural condition?

Yes X No N/A

Current Condition Description: The unit is located approximately 30 miles southwest of the community of Burns. The unit consists of flat to gently rolling hills with one larger dry lake playa and several smaller playas. Vegetation is primarily big and low sagebrush, rabbit brush, grasses and some greasewood.

There have been some limited vegetative treatments consisting of a 273-acre fire rehabilitation seeding that was drilled seeded with non-native crested wheatgrass that is still observable as an unnatural feature. There is frequent and extensive off-road use by motorized vehicles in the playas. The unit currently has the following developments (**See Unit Character Map**):

- 4.1 miles of interior routes (non-boundary roads)
- 4 miles of fencing
- 1 mile of dikes
- 3 waterholes
- 2 gates

The ID-team found that many of these developments and treatments were along the outer edges of the unit or dispersed enough that the imprint of humans is still substantially unnoticeable. The unit does have naturalness.

(3) Does the unit have outstanding opportunities for solitude?

Yes No X N/A

Current Condition Description: The unit has very little vegetative and topographic screening for its relatively small size. The presence of motorized vehicles in the playas also contributes to there being a lack of areas for visitors to escape the sites and sounds of others. The ID-team found that this unit does not offer outstanding opportunities for solitude.

(4) Does the unit have outstanding opportunities for primitive and unconfined recreation?

Yes No X N/A

Current Condition Description: The unit does have opportunities for hiking, hunting and horseback riding. The 1992 Three Rivers RMP/ROD

show that this unit is open to off-road use by motorized vehicles and this off-road motorized vehicle use may detract from those seeking a more primitive and nonmotorized experience. The ID-team determined that the unit's recreational opportunities are neither collectively nor individually possess attributes which would provide outstanding opportunities for primitive or unconfined recreation.

(5) Does the unit have supplemental values?

Yes _____ No _____ N/A X

Summary of Findings and Conclusion

Unit Name and Number: **West Warm Springs Unit 2**

Summary Results of Analysis:

1. Does the area meet any of the size requirements? X Yes ___ No
2. Does the area appear to be natural? X Yes ___ No
3. Does the area offer outstanding opportunities for solitude or a primitive and unconfined type of recreation? ___ Yes X No ___ NA
4. Does the area have supplemental values? ___ Yes ___ No X NA

Conclusion (Check One):

- ___ The area-or a portion of the area-has wilderness character.
- X The area does not have wilderness character.

Prepared by: Laura Dowlan, Wilderness Specialist

Team Members:

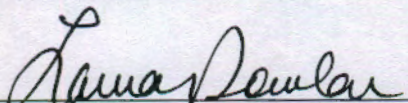
Laura Dowlan, Outdoor Recreation Planner (Wilderness Specialist) – Burns District
Date 9/5/08

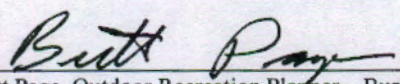

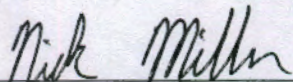
Brett Page, Outdoor Recreation Planner – Burns District
Date 8/20/08

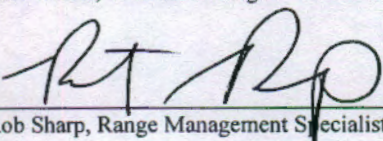

Nick Miller, Wildlife Biologist – Burns District
Date 8/18/08

Rob Sharp, Range Management Specialist – Burns District
Date 8/22/2008

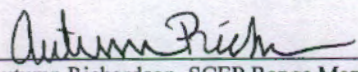

Ronda Purdy, Range Technician – Burns District
Date 8-12-08

Fred McDonald, Supervisory Natural Resource Specialist – Burns District
Date 8/22/08

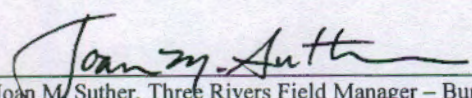

Willie Street, Range Management Specialist – Burns District
Date 8-11-2008

Autumn Richardson, SCEP Range Management Specialist – Burns District
Date 8-11-2008

Approved by:

Joan M. Suther, Three Rivers Field Manager – Burns District
Date 8/27/08

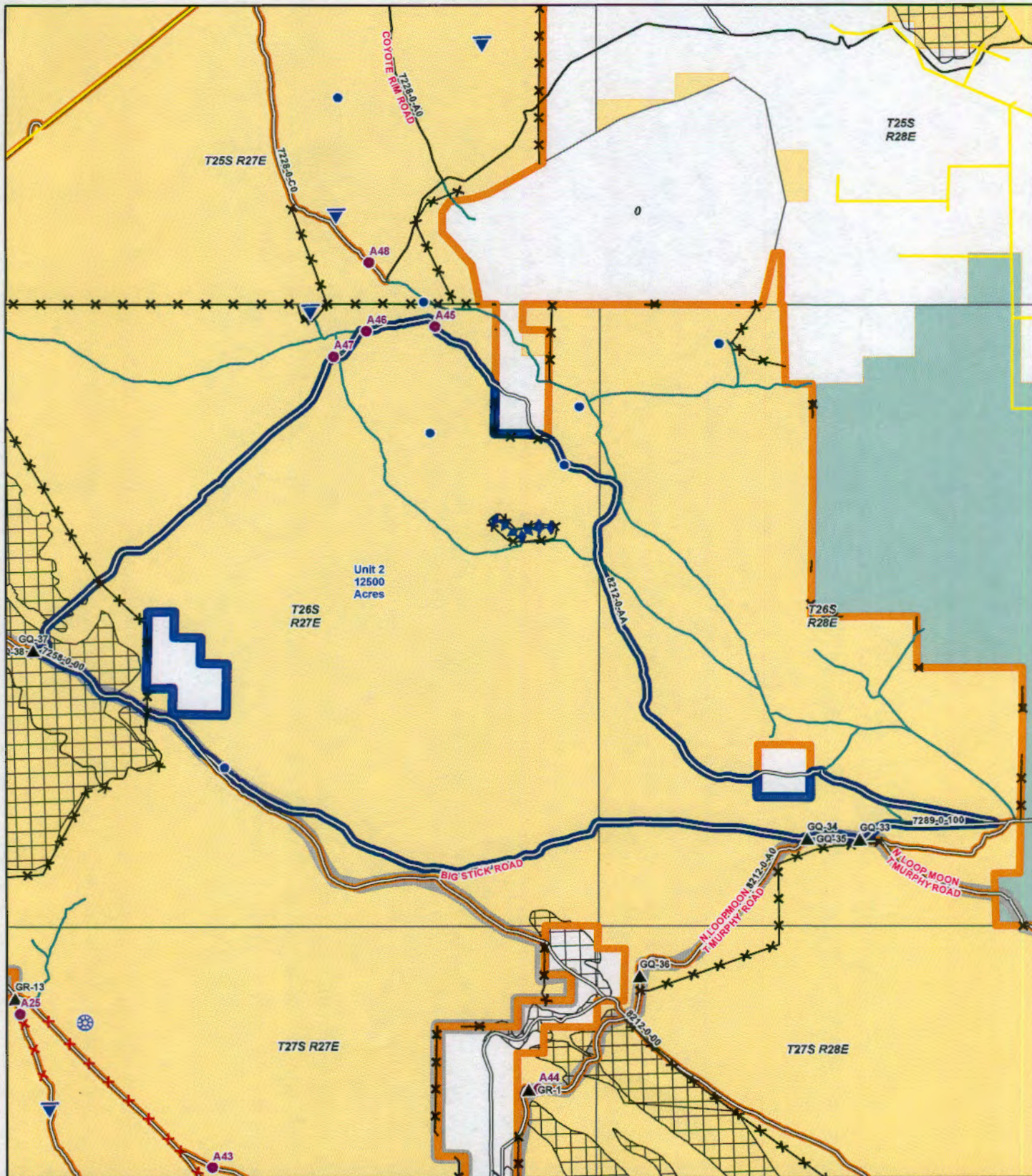
This form documents information that constitutes an inventory finding on wilderness characteristics. It does not represent a formal land use allocation or a final agency decision subject to administrative remedies under either 43 CFR parts 4 or 1610.5-2.02



West Warm Springs Wilderness Character Unit Map ~ 2

- | | | | | |
|-------------------------|-------------------------|-------------|-----------------|----------------------------|
| Unit | Mineral Materials Sites | STUDY PLOT | BRUSHBEAT | Powerlines |
| Adjacent Units | CATTLE GUARD | TANK | DIKE | Wildfires 2002 to Present |
| BLM Photo Points | CORRAL | WATERHOLE | DRIFT FENCE | Bureau of Land Management |
| ONDA Photo Points | GATE | WELL | FENCE | BLM Wilderness Study Area |
| ONDA Unit Buzzard Creek | RESERVOIR | Major Roads | PIPELINE | State |
| Burns District Boundary | | | SNOW FENCE | U.S. Fish & Wildlife |
| | | | EXCLOSURE FENCE | No. Great Basin Exp. Range |
| | | | SEEDING | Private |

Note: No warranty is made by the Bureau of Land Management as to the accuracy, reliability or completeness of these data for individual or aggregate use with other data. Original data was compiled from various sources. This information may not meet National Map Accuracy Standards. This product was developed through digital means and may be updated without notification. Ownership boundaries are accurate to within plus or minus 200 feet.

US DEPARTMENT OF THE INTERIOR
 Bureau of Land Management
 Burns District, Oregon
 Three Rivers Resource Area

projects\WSAInventoryReview\WestWarmSp\IndividualUnit8X11NoAnno.mxd for Laura Dowlan
 January 11, 2007

All legend elements may not appear on this map.

