

Memo

August 29, 2012

To: Files – Vale District Wilderness Characteristics (WC) Inventory – WC
Inventory units: OR-036-003 Cairn C; OR-036-004 Oregon Butte; OR-036-005
Deer Flat; and OR-036-033 Long Ridge

From: Pat Ryan, Field Manager, Malheur and Jordan Resource Areas, Vale District
Robert Alward, Wilderness Planner, contractor, Vale District *RA*

Subject: WC Status of WC units OR-036-003 Cairn C; OR-036-004 Oregon Butte; OR-
036-005 Deer Flat; and OR-036-033 Long Ridge OR-036-101, as they relate
to the status of Winnemucca District's WC Inventory

The four Subject Vale District wilderness characteristics (WC) inventory units are considered by Vale District to be contiguous to adjacent preliminarily identified (by Vale District) WC inventory units within Winnemucca District. The present identifier for each of the Winnemucca preliminary WC inventory units has been assigned by Vale District. These identifiers are preliminary, to eventually be replaced by identifiers (and WC inventory unit names) which Winnemucca District would eventually establish.

In 2007 and 2010 Vale District identified – and with related WC inventory findings determined – WC inventory units within Vale District along the NV state line. OR-036-003 is contiguous to Winnemucca District's NV-01000-VL3; OR-036-004 is contiguous to NV-01000-VL4; OR-036-005 is contiguous to NV-01000-VL5; and OR-036-033 is contiguous to NV-01000-VL33 (see the attached 4 Vale District - generated maps). Refer to the WC file of each of Vale District's Subject WC inventory units for the current (2007 and 2010) Vale District WC inventory findings.

To date during 2012, following the 2011 BLM national issuance of instruction for conducting WC inventory, Vale District has renewed coordination efforts with Winnemucca District for updating WC inventory of public lands bordering the two district's common administrative boundary (State line). Vale District provided Winnemucca District copies of its applicable 2007 and 2010 Form 1, Form 2 and associated map(s) for the 4 WC inventory units bordering that district. Inter-district coordination efforts are reflected in copies of e-mails retained in the Vale District WC files (hard copy) for each of the 4 units.

When Winnemucca District provides Vale District its WC inventory maintenance information, and as a result should updates of WC maintenance be mutually determined to be needed for an inventory unit, then Vale District will incorporate the new information, and a copy of the updated WC inventory maintenance records for the unit(s) will be provided to Winnemucca District. Until such time, the applicable 2007 and 2010 WC findings within Vale District for the 4 Vale District WC inventory units remain unchanged.

Wilderness Characteristics - Overview Map

Oregon Butte, OR-036-004 / ID-106-70E / NV-01000-VL4

Map 1 of 1

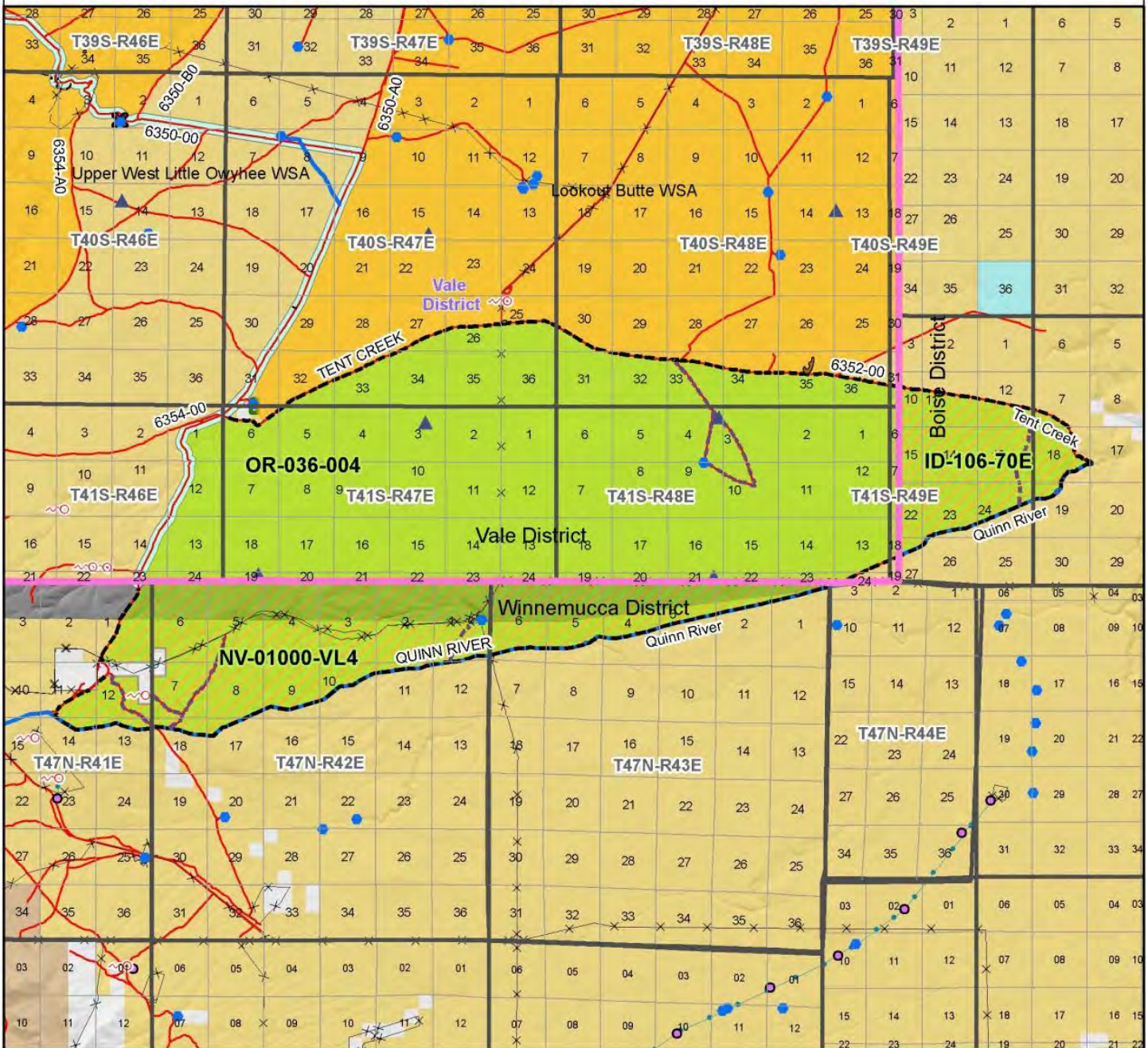

Legend

- S Developed Spring
- ▲ Wildlife Guzzler
- Earthen Reservoir
- X Fences
- Pipeline
- Trough
- ◆ Storage Tank
- X Surface Mining Disturbance
- ▲ Sage Grouse Lek
- Special Status Plant
- OR Wild Char Inventory Unit
- ID & NV Wild Char Inventory Unit
- Wilderness Study Area
- Mineral Material Site
- Road/Utility Right-of-Way
- Major Water Body

Route Types - BLM Determination

- Boundary Road
- Motorized Primitive Trail (MPT)
- Discontinued Use

Routes - Outside Wild Char Unit

- County
- Major Highway
- BLM Numbered & Other Routes

Land Ownership

- Bureau of Land Management
- State
- Private
- Other Federal Land
- District Area Boundary

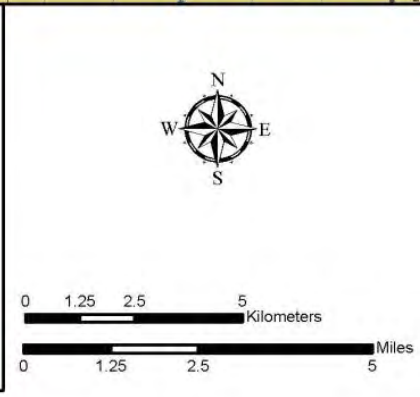
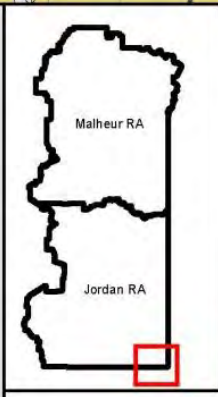

U.S. DEPARTMENT OF THE INTERIOR
BUREAU OF LAND MANAGEMENT

VALE DISTRICT
April 26, 2012

No warranty is made by the Bureau of Land Management as to the accuracy, reliability, or completeness of these data for individual or aggregate use with other data. Original data were compiled from various sources. This information may not meet National Map Accuracy Standards. The product was developed through digital means and may be updated without notification.

--FINAL--

Wilderness Characteristics - BLM Photo Points
Oregon Butte, OR-036-004 / ID-106-70E / NV-01000-VL4

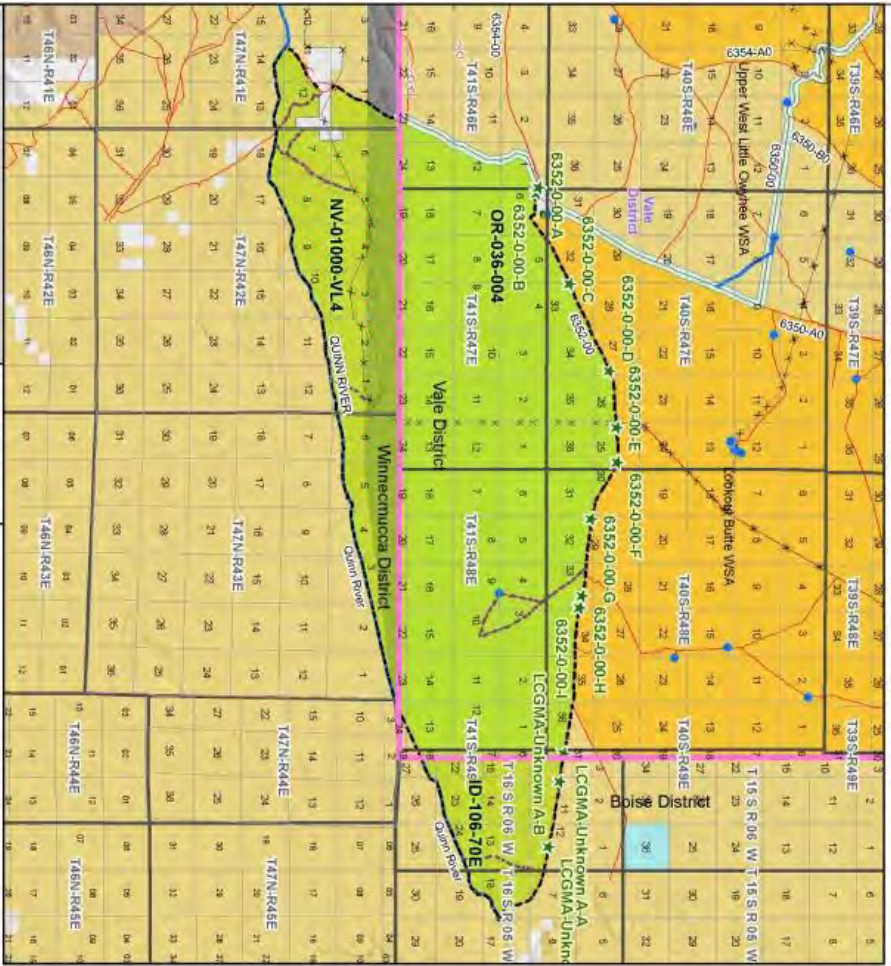

Legend

★ Feature	● Road Type: BLM Designation
● Developed Spine	● Boundary Road
● Wildlife Corridor	● New Material Property Trail (NPT)
● Eastern Powerline	● Kaden / Corral Wild Horse Use
● Riparian	● Clear
● Mixed Natural Site	● Major Highway
● Road Utility Row	● BLM Numbered & Color Zones
● Wilderness Study Area	● Old Wild Char Inventory Unit
● BLM Wild Char Inventory Photo Points	● Old Wild Char Inventory Unit
● Old Wild Char Inventory Unit	● U.S. BLM Wild Char Inventory Unit

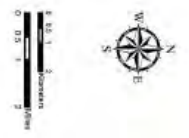
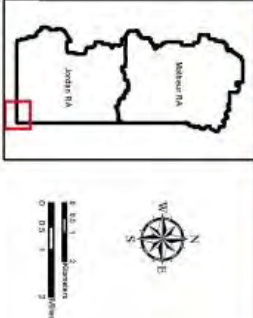

U.S. DEPARTMENT OF THE INTERIOR
BUREAU OF LAND MANAGEMENT

VALE DISTRICT
 April 26, 2012

Map scale: 1 inch = 10 miles
 1:62,500
 This map was prepared by the Bureau of Land Management, Vale District, under contract to the National Center for Geographic Information Science (NCGIS) at the University of North Carolina at Chapel Hill. The map is based on the Oregon State Plane Coordinate System (OSPCS) Zone 10N, North American Datum of 1983 (NAD83). The map is not to be used for any purpose other than that for which it was prepared.

—FINAL—

Wilderness Characteristics - BLM Photo Points
Oregon Butte, OR-036-004 / ID-106-70E / NV-01000-VL4

PHOTO_LOCATION*	DIRECTION	PHOTO_TYPE	PHOTO_DATE	COMMENTS
LOGMA-Unknown A-C	W	Route	20070417	Beginning
LOGMA-Unknown A-B	W	Route	20070417	Visible Road
LOGMA-Unknown A-A	W	Route	20070417	Visible Road
6352-0-00-G	W	Route	20070417	Visible Road
6352-0-00-I	W	Route	20070417	
6352-0-00-H	E	Route	20070417	Looking Back At Tent Creek
6352-0-00-B	W	Route	20070417	Just Inside Tent Creek Pasture
6352-0-00-F	W	Route	20070417	End Of Road
6352-0-00-D	W	Route	20070417	Start Of Orda Disputed (blacked)
6352-0-00-C	W	Route	20070417	Just Inside S Tent Creek
6352-0-00-A	W	Route	20070427	

Note: The BLM Wild Char PhotoPoints displayed on the map are labeled with their Photo Locations. The BLM Photo Log table shown above lists the photos taken at their respective Photo Locations. Multiple photos may be taken at each Photo Location. Scenery and Project Photo Type pictures have their photo names provided in the Comments field.